

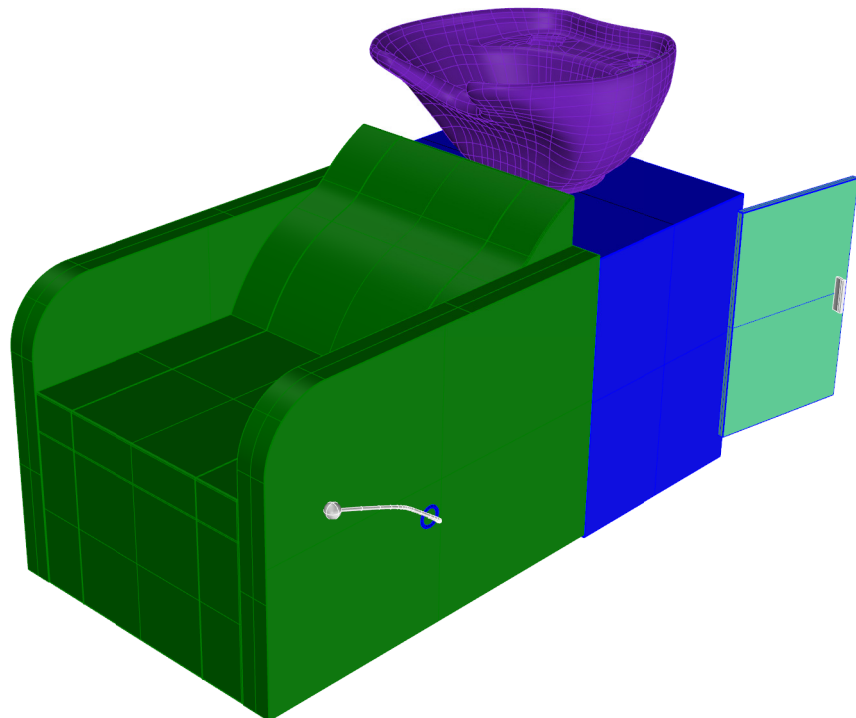

Hashima Backwash Assembly Instructions

Sku# 5850



Hardware

Part	Qty.	Description	Sketch
A	4	Lock Washer	
B	4	Washer	
C	4	Nut	

*Check inside all boxes, cabinets, and drawers for boxes and bags of parts before beginning assembly.

Components

Chair - 1

Base - 2

Bowl - 3

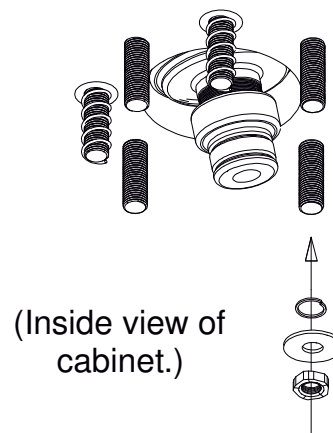
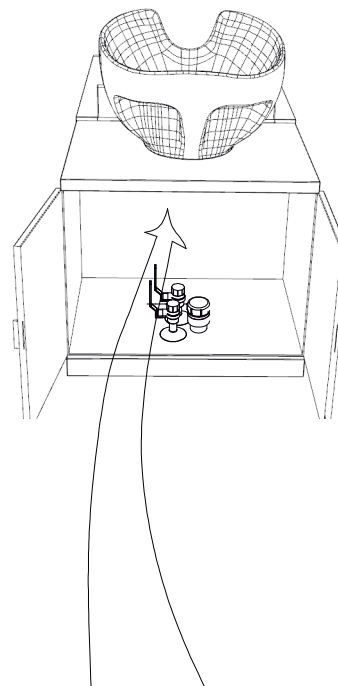

(Inside view of cabinet.)

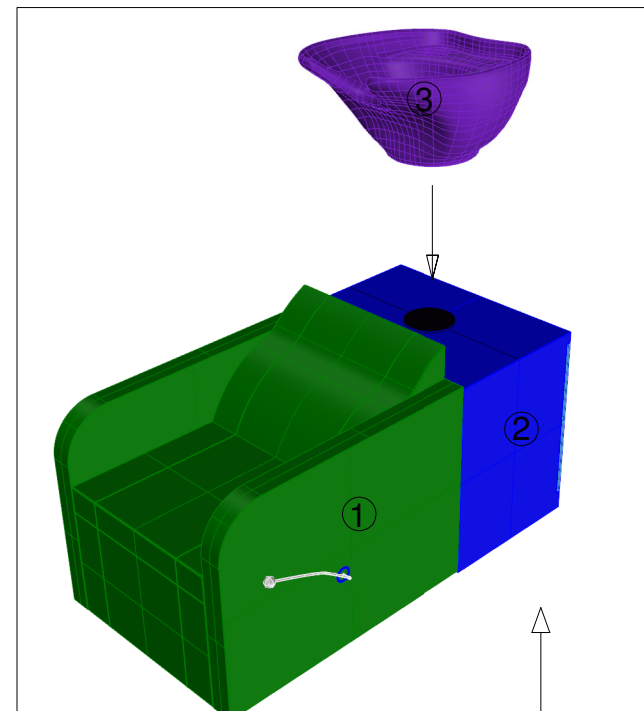

Instructions

- 1) Insert sink(3) into the holes on top of the chair and base(2)
- 2) Slide 1 lock washer(A) followed by 1 washer(B) and a nut(C) into bolt connected to the sink(3)
- 3) Repeat for the 3 remaining bolts